

# FOR LEASE

## 17671 METZLER LN., HUNTINGTON BEACH MAJOR CROSS STREETS: GOTHARD AND SLATER

### Multi Tenant Building

AVAILABLE SIZES  
FROM 1,129 - 3,680  
SQUARE FEET



### FEATURES

- Industrial Warehouse Space
- 2:1 Parking Ratio
- 1 Roll-up Truck Door
- Fire Sprinklered
- 3 Phase Power
- Near 405 Freeway
- Business Park Environment

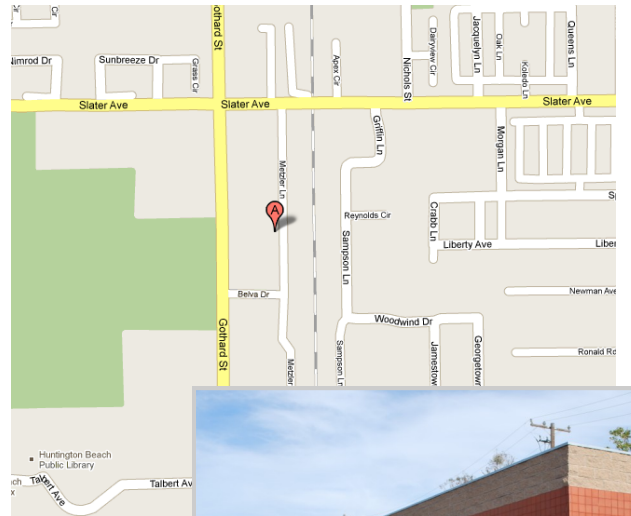

For information contact:

**Jordan De Meis**

Lic. # 01312030

[jdemeis@swcre.com](mailto:jdemeis@swcre.com)

**Ronnie Thornton**

Lic. # 01896439

[rthornton@swcre.com](mailto:rthornton@swcre.com)

Southwest Commercial  
3000 W. MacArthur Blvd.  
Suite 685

Santa Ana, CA 92704

**714.434.4831**

[www.swcre.com](http://www.swcre.com)

Southwest

 **Commercial**

Commercial Real Estate Services

*The information contained herein has been obtained from the owner of the property or from other sources we deem reliable. We have no reason to doubt its accuracy, but we do not guarantee it.*

**17671 METZLER LN., HUNTINGTON BEACH**  
**MAJOR CROSS STREETS: GOTHARD AND SLATER**

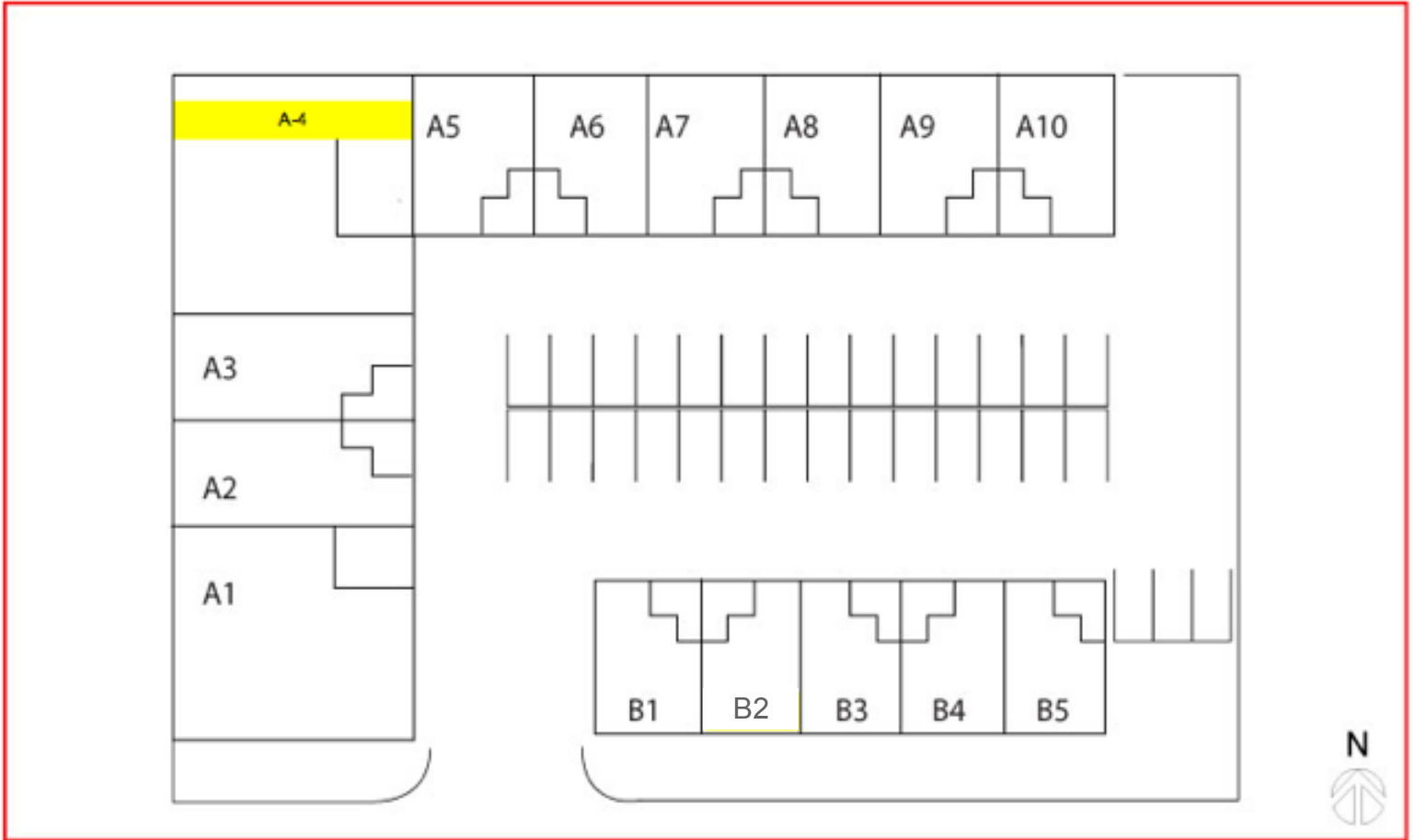

For more information contact:

**Jordan De Meis**  
Jdemeis@swcre.com  
Lic. # 01312030

**Ronnie Thornton**  
rthornton@swcre.com  
Lic. # 01896439

**714.434.4831**